

Steelcase®

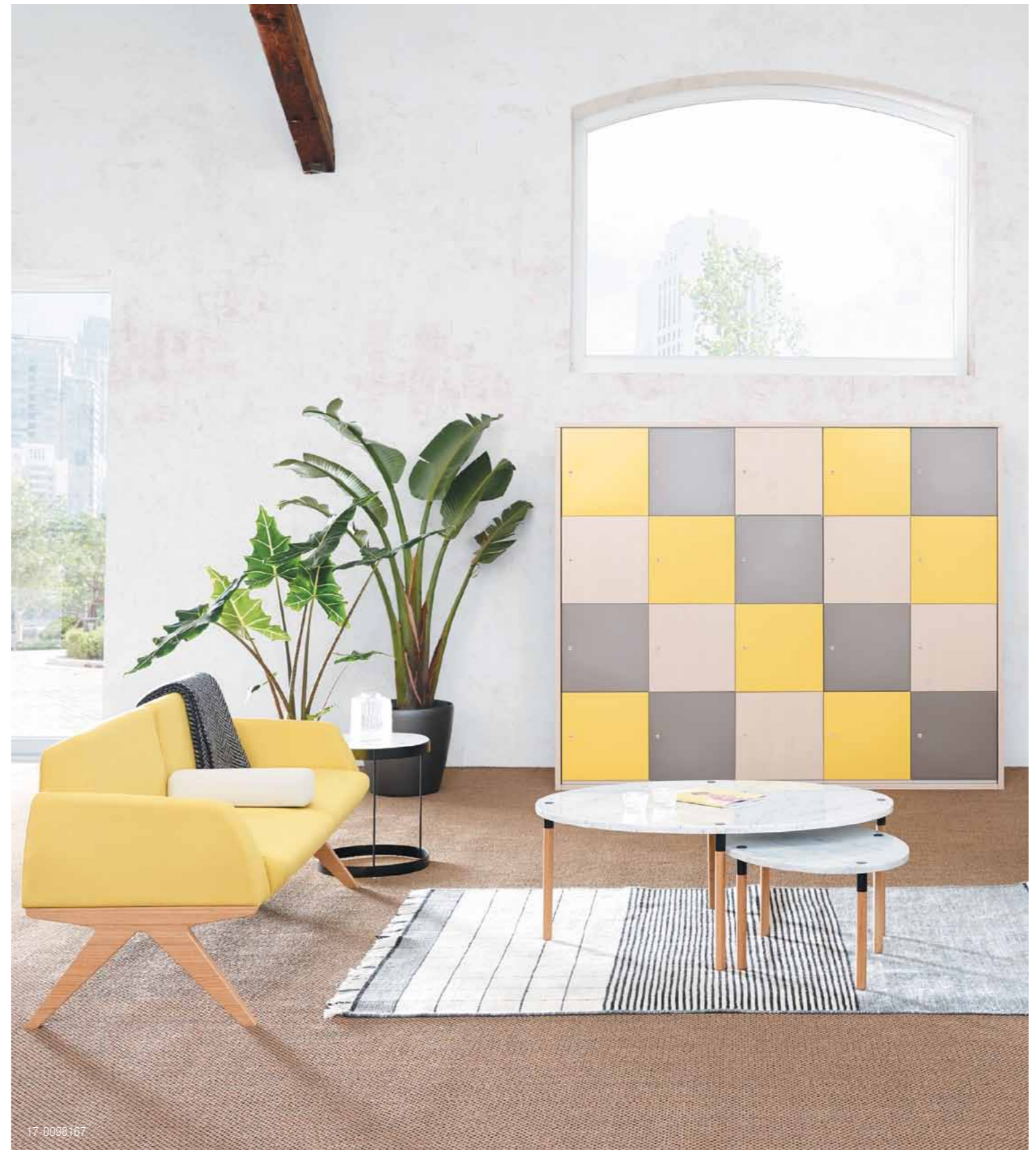

17-0098167

Lockers Collection
Storage

Visit steelcase.com

 facebook.com/Steelcase  twitter.com/Steelcase  youtube.com/SteelcaseTV

Concept and Design / Steelcase
19-E0000422 07/19 © 2018 Steelcase Inc. All rights reserved. All specifications subject to change without notice.
Printed on at least 60% recycled paper. Cert no. BV-COC-858659. Printed in France by OTT Imprimeurs – Wasselonne.



Steelcase



Shaping the new office landscape

As the nature of work shifts from creating alone to creating together, a new office landscape is emerging. It's an environment that hosts spaces for time alone and time with others, often in shared spaces. As the office evolves, storage needs to evolve with it.

Storage can no longer just store. Whether owned by an individual worker, or placed in a nomadic space, the new line of lockers provides personal storage, privacy and space division. It fosters collaboration with the ability to display information and keeps team members connected by creating a shared space. Lockers are a versatile tool to use throughout the office ecosystem.

Versatility across the office

The new lockers portfolio fits users' needs anywhere in office. A variety of sizes offer storage for everything from small personal items to luggage and wardrobes. Different heights and widths provide options to create space division in the open plan.

The ability to add whiteboard surfaces gives residents or nomads a place to share information with their team or spontaneously collaborate. Lockers within reach help create a home base for mobile or resident workers, letting them focus on work and not the security of their things.

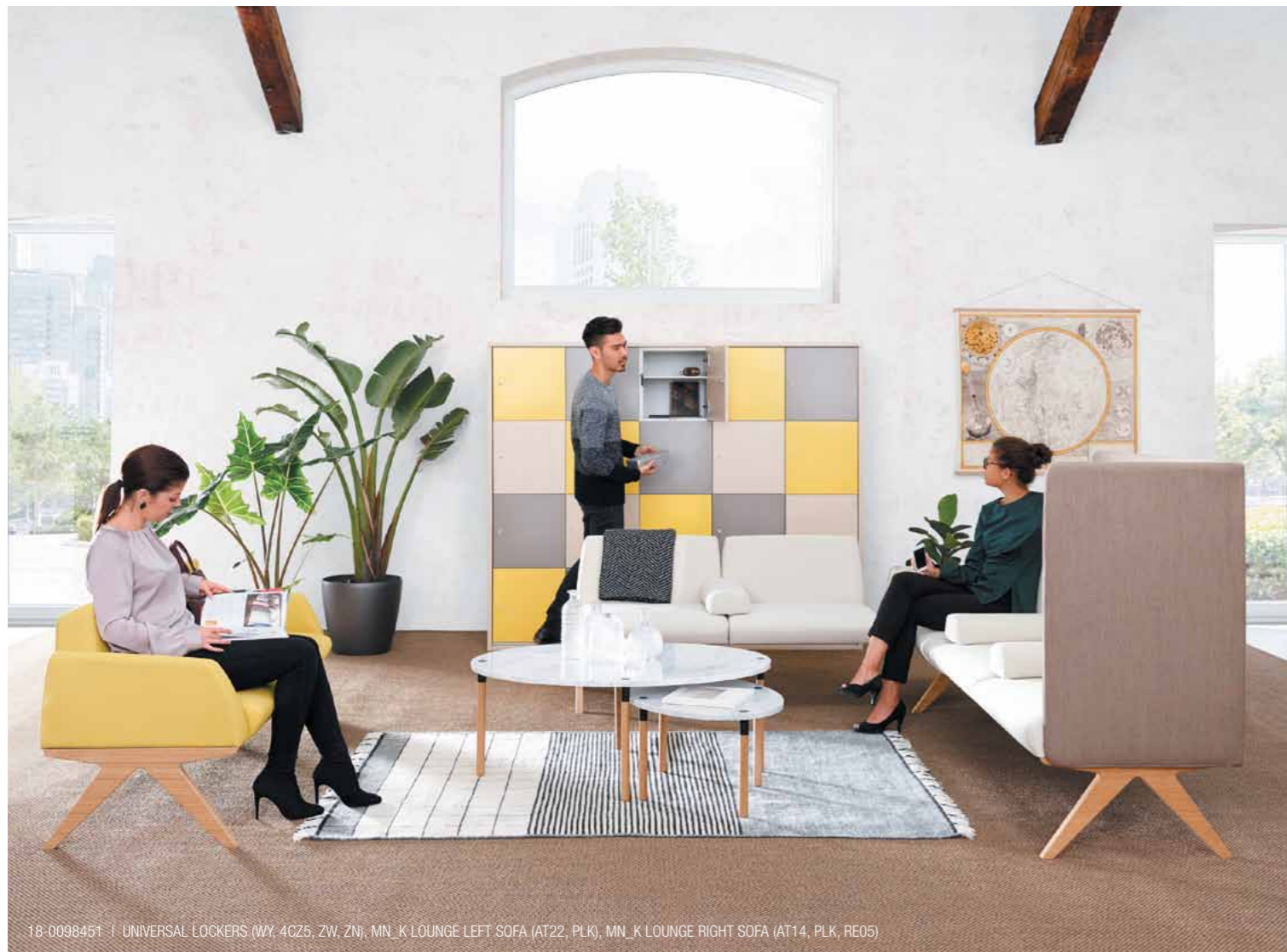

Personalised storage

Express your brand and culture with a wide range of materiality options. Lockers fit any aesthetic with choices in melamine, metal or textiles in a variety of colors.



MOBILE WORKER

Lockers allow mobile workers to settle into a space quickly, giving them peace of mind and a place to store their things out of the way.



RESIDENT WORKER

Larger lockers offer a convenient place for coats, gym bags and lunch, letting residents get to work and stay organized.



ASSIGNED MOBILE WORKER

Assigned lockers give mobile workers the much needed place to store personal belongings as they move throughout the office, allowing space to stay clear for other nomadic workers.



SPACE DIVISION

Create neighborhoods, meeting spaces, a team zone or a space to rejuvenate. Lockers provide a shield for those trying to focus and give a sense of ownership to teams by defining a space.



COLLABORATION

Give workers a space to create together. Lockers with whiteboards or pinnable textile foster collaboration while providing valuable storage space on the opposite side.



TEAM STORAGE

Shared storage between team members saves time and helps keep projects organized.



19-0115284
 UNIVERSAL LOCKERS (WM, PB), STEELCASE SERIES 1 (5T20, 644 CNA05, B7), FRAMEONE BENCH (WY, WM), DIVISIO ACOUSTIC SCREEN (AT15), OFFICEBRICKS PHONE UNIT (PETROL 16)

Locks options

The Lockers Collection offers diverse locking systems, from traditional key locking systems to more advanced keyless solutions. Intuitive, keyless locks are easy to use and to access. Providing enhanced management opportunities, a master key for emergencies and battery back-up. The keyless locks are available as an option on all Volum Art and Universal Lockers.



RFID

A quick swipe of a badge accompanied by a visual and audible indicator easily opens the locker door.



KEYPAD

The electronic keypad is a familiar and simple solution, allowing everyone to use lockers by setting up a personal digital code.



DIAL

The manual dial lock is a "battery-less" keyless lock solution. Simply rotate and enter the user selected code.



KEYS LOCK

Keyed locks are the classic lock solution for lockers and available on all storage ranges.

Volum Art Lockers

Volum Art is the perfect solution for residents who need storage close by. Bring the outdoors in to increase worker wellbeing with options for planter and open box shelves. Foster connection and impromptu discussion among team members with standing height cabinets.

STATEMENT OF LINE

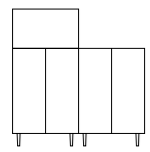

Height: H1000mm
Width: W800/1000mm
2 personal lockers*

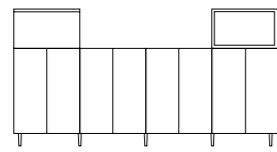

W800mm is available with/without planter/open box shelf*



Standard module

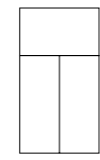

Stackable unit

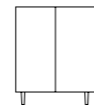

Wooden legs

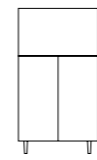

Stackable unit and wooden legs

*2 personal lockers each.



19-0115304

Share It Lockers

Everything you love about Share It Lockers is now available in one and two file height door options.

STATEMENT OF LINE

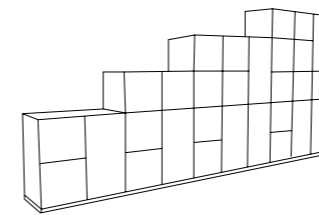

Keeping existing lockers range and adding 1FH and 2FH within the same storage body. Lock options: dial lock is added to the standard key lock option. Surface materials and options will be the same as on Share It collection lockers.



Lockers and wardrobes 8 and 19mm doors

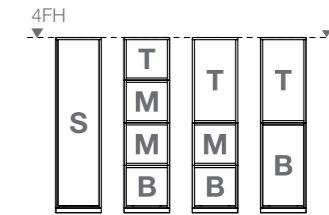

S = Single unit: 2FH – 6FH
B = Modular bottom unit: 1FH – 4FH
M = Modular middle unit: 1FH – 2FH
T = Modular top unit: 1FH – 4FH



17-0080426



16-0058806



18-0112384

Universal Lockers

Perfectly suited for shared spaces, Universal lockers are great for mobile workers and visitors. With a wide variety of heights and widths, Universal suits any space. Easily create an open meeting space with Universal lockers that cater to collaboration. Whiteboards and pinnable surfaces display and share work to boost team identity and creativity.



18-0098444 | UNIVERSAL LOCKERS (2LCN, HU A04, HU A07, HU A09, HU A20), B-FREE BEAM (AT14, H6), TOUCHDOWN (2LCN, WM)



18-0100311



19-0115267

STATEMENT OF LINE

3FH LOCKER CABINETS

H1240mm D450mm W800/1200mm (2 or 3 columns)



Back options:
melamine / textile tiles or back

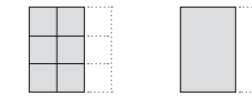

4FH LOCKER CABINETS

H1645mm D450mm W800/1200mm (2 or 3 columns)

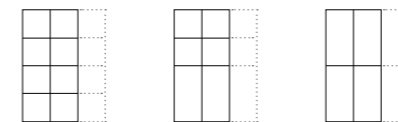

Back options:
melamine / textile tiles and back, and in addition whiteboard or pinboard

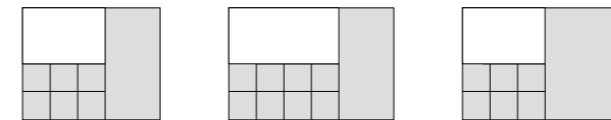

4FH WARDROBES

H1645mm D450mm W1200mm

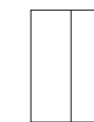

Whiteboard:
H800mm
W1200/1600/2000mm
Pinboard:
W800/1200mm

4FH FRAMES

H1700mm D555mm W2055/2455mm



Back options:
same as 4FH
backs without frame

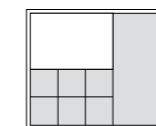

5FH LOCKER CABINETS

H2050mm D450mm W800/1200mm (2 or 3 columns)

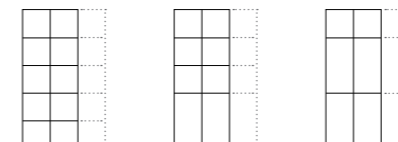

No back options available.
5FH Locker Cabinets need
to be fixed to the wall.

SURFACE MATERIALS

Surface materials shown in brochure:

WY Snow	AT14 Coconut	4CZ6 Lagoon
4CZ5 Honey	H6 Chalky white	HU A10 Paprika
ZW Pearl snow	WM Arctic white mat	MG Merle
ZN Pearl Grey 0	AT15 Scarlet	HX Solid beech
AT22 Canary	WG Arctic white gloss	PB Pearl black
PLK Plywood natural oak	AT24 Graphite pepper	Petrol 16
2LCN Clay noce	ET Natural maple	B7 Seagull
HU A20 Oregano	Remix RE05 beige	
HU A09 Clove	4CZ3 Jungle	
HU A07 Ginger	4CZ7 Saffron	
HU A04 Sea salt	4CZ4 Merlot	

Colours are representative and may vary slightly from actual material.

SUSTAINABILITY

DESIGNING FOR THE ENVIRONMENT REQUIRES INNOVATIVE THINKING AND SOLUTIONS.

At its heart, sustainability at Steelcase is about people. It's about creating and supporting the economic, environmental and social conditions that allow people and communities to reach their full potential.

Research and insights direct our path. It's not only about creating goods, it's about creating good. It's not only about creating value, it's about living our values. It's not just about reducing our footprint, it's about expanding our reach. It's about creating lasting and meaningful change to enable the long-term wellbeing of current and future generations.

Innovative products and solutions result. In the development of our products, we work to consider each stage of the life cycle: from materials extraction, production, transport, use and reuse, until the end of its life. We demonstrate performance through third-party verified certifications and voluntary product declarations.

Steelcase's sustainability promises, actions, and results are communicated in an annual Corporate Sustainability Report.